

(De)monteren front van dubbele klepkast / How to fix and dismantle front of wall unit with 2 large flapdoors

Waarschuwing / Warning

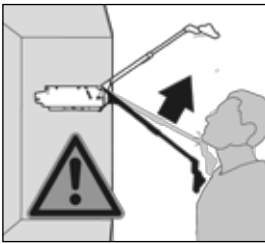

Risico tot verwondingen door omhoogverende telescopische arm.

Risk of injury by spring-loaded telescopic arm.

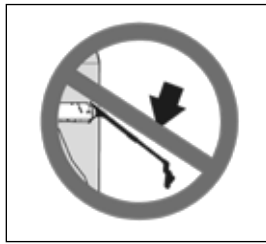

De hefboom niet naar onder duwen maar demonteren.

Do not push telescopic arm down without door attached but remove.

Montage bovenste front dubbele klepkast / Fitting top front of wall unit with 2 large flapdoors

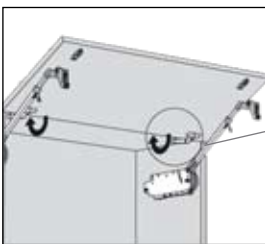

Montage onderste front dubbele klepkast / Fitting bottom front of wall unit with 2 large flapdoors

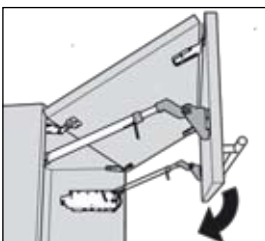
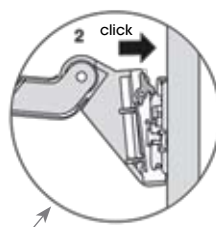
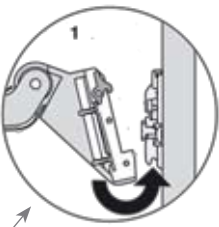
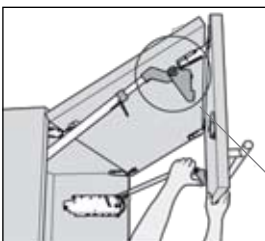
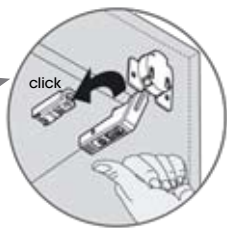
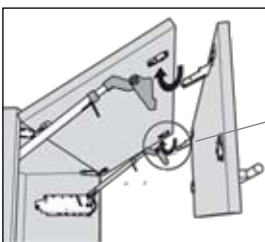

(De)monteren front van dubbele klepkast / How to fix and dismantle front of wall unit with 2 large flapdoors

Instelling beslagelement / Adjustment mechanism

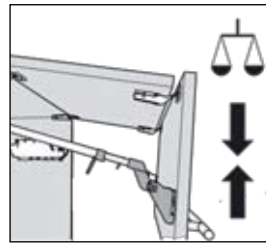
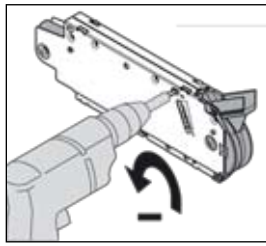
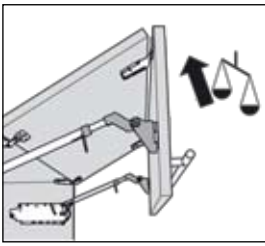
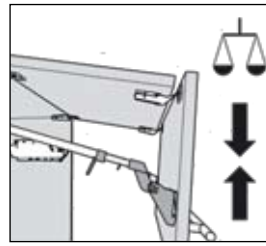
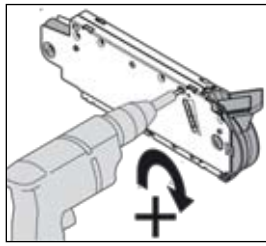
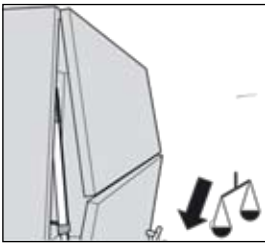

Front afstellen / To adjust the front

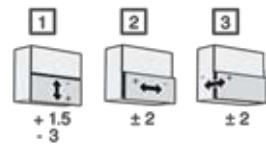
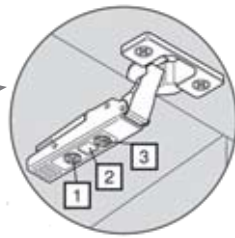
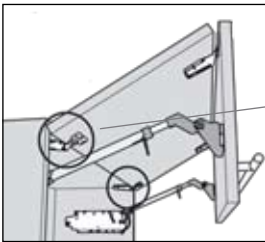

Scharnier boven
Top hinge

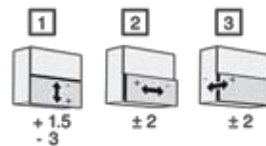
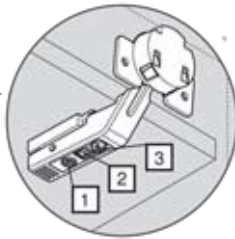
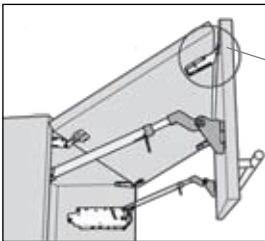

Verbindingscharnier
Hinge between 2 front parts

Montage / assembling

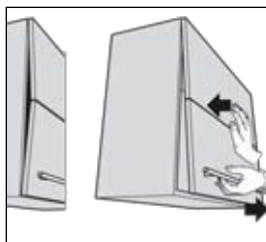
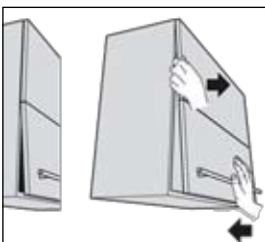

(De)monteren front van dubbele klepkast / How to fix and dismantle front of wall unit with 2 large flapdoors

Instelling telescopische arm / To adjust telescopic arm



Demontage / Removal

